



**LAN  
SER  
HOF**

THE NEW  
LANSERHOF MARBELLA

HOME OF HEALTH AND BEAUTY

There are places where you instantly feel that everything is in harmony – landscape, architecture, light and atmosphere. For me, it is therefore a very special pleasure to bring the Lanserhof experience to one of the most beautiful regions of Europe with Lanserhof Marbella, and to realise our long-anticipated expansion. At the beginning of 2027, we will open the first Lanserhof on the Mediterranean – on the exclusive grounds of the renowned Finca Cortesin, between Marbella and Gibraltar: a breathtaking natural setting that offers tranquillity, openness and inspiration all at once. This marks a significant milestone in our 40-year history, as we make our premium health and longevity concept, guided by the philosophy *Home of Health and Beauty*, tangible in a completely new climate. Here, Mediterranean lightness, the power of nature and our unique LANSERHOF CONCEPT come together in a place that brings the focus back to what truly matters: one's own health.

Over an area of 24,000 m<sup>2</sup>, 71 rooms and suites, state-of-the-art medical facilities and cutting-edge technologies will be created, turning our proven Lanserhof philosophy of health, prevention and regeneration into a truly unique experience. Our architectural vision is inspired by the cultural heritage of Andalusia and the Moorish style, in particular the historic Alhambra, which we have reinterpreted for the 21st century. The design combines flowing forms, light-filled spaces and a central courtyard with water features. Lanserhof Marbella will unite the very best of our global expertise – from our established medical longevity concepts to carefully selected culinary and cultural influences of the region – creating a truly exceptional retreat on the Mediterranean. It fills me with great pride that, 40 years after the opening of our first property in Lans, Austria, we are once again fulfilling a long-cherished dream and making our expertise accessible in southern Europe.

I very much look forward to welcoming you soon at Lanserhof Marbella, where a new chapter of our vision for sustainable health begins.

Yours sincerely,  
DR CHRISTIAN HARISCH  
CEO Lanserhof Group





## EUROPE'S MOST MODERN HEALTH RESORTS IS COMING TO SPAIN

Come and experience the creation of a new class of health resort in one of Europe's most beautiful nature setting.

At the beginning of 2027, we will open the first Lanserhof in southern Europe – on the exclusive grounds of the renowned Finca Cortesin, just outside Marbella. As one of Spain's leading resort hotels, Finca Cortesin is celebrated for its award-winning hotel and outstanding golf course – a location perfectly aligned with our philosophy.

“From north to south – following the successful launch of our Sylt resort, we are delighted to now also be represented in southern Europe. This is a significant milestone for the Lanserhof Group, as we seek to expand our offering and enable even more people to access our world-class health services. Our collaboration with AltamarCAM and GPF Capital is a valuable opportunity to extend our expertise across Europe.

Together with AltamarCAM and Inbest-GPF, we are investing €93 million in a state-of-the-art building that meets the highest sustainability standards. Across 23,500 m<sup>2</sup>, 71 rooms and suites will be created, alongside first-class medical facilities, cutting-edge technologies, and exceptional services – all in line with the highest Lanserhof standards.





## THE LANSERHOF ART OF HEALING

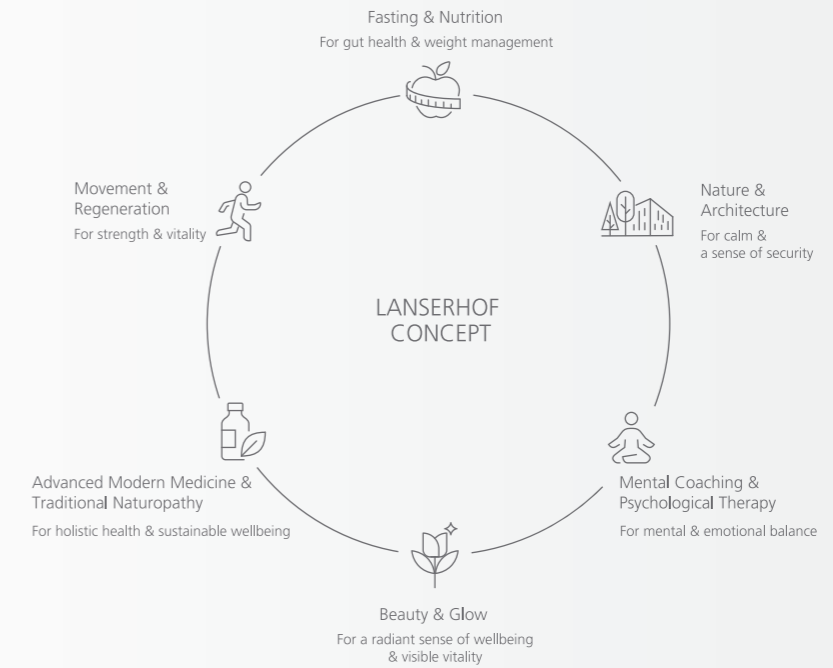

Developed over three decades and practised to perfection at Lanserhof on a daily basis, the award-winning Lanserhof Concept is the combination of the most valuable insights that nature and science have to offer: Wisdom of traditional naturopathy, energy medicine, psychology and psychoneuroimmunology, chronomedicine and advanced modern medicine.

Our approach is a thoroughly holistic one.

At Lanserhof, we see people as a whole and treat them accordingly, from the crown of their head to the tip of their toes. Beyond simply fighting illness, our sophisticated approach actively promotes health.

A harmonious atmosphere pervades Lanserhof. Once you visit, you will be able to breathe freely and feel protected at all times, bathed in a warm sense of security. This is essential in our eyes, as well as being a prerequisite for rebalancing the mind, body, and soul. Another absolutely crucial element is the intensive personal contact that you share with the doctor and therapist who treat you.

Empathy and affinity form the basic components of the Lanserhof Concept and Lanserhof Cure.

Individual exercise therapy sessions, our specially designed Lanserhof Energy Cuisine concept, and our extensive physical therapy programme all accelerate and strengthen the holistic regeneration process. This is underlined by the breathtaking scenery, which banishes thoughts of the hustle and bustle of everyday life.

Come to Lanserhof and open your heart and soul to a unique experience. We will help you to activate the reserves deep within you and reach your full potential. By the time you leave, you will feel free, light and revived once again.

The Lanserhof Concept will continue to work its miracles on your body even after you return home. It also teaches you a very valuable art:

The healing power of mindfulness.

# LANSERHOF MARBELLA

## KEY FIGURES

Property size:	19.800 m <sup>2</sup>
Building size:	23.500 m <sup>2</sup>
Building height:	12.75 m
Number of rooms:	71
Area of the medical section:	2.900 m <sup>2</sup>
Area of the spa, wellness, and exercise section:	1.840 m <sup>2</sup>
Total investment:	€ 93 million
Start of construction:	Q3 / 2024
Opening:	Q1 / 2027



# LANSERHOF MARBELLA ARCHITECTURE

## BASEMENT:

Medical services, Spa, indoor pool, underground parking, storage, etc.

## GROUND FLOOR:

Rooms, reception, lobby, shop, library, restaurant, pool, back office

## UPPER FLOOR:

Suites & Rooms (size: 72 m<sup>2</sup> - 117 m<sup>2</sup>)

Suites (total 9):

Suite Junior 1 – 72 m<sup>2</sup>

Suite Junior 2 – 72 m<sup>2</sup>

Suite 1.1 – 117 m<sup>2</sup>

Suite 1.2 – 117 m<sup>2</sup>

Suite 1.3 – 117 m<sup>2</sup>

Suite 1.4 – 117 m<sup>2</sup>

Suite 2.1 – 112 m<sup>2</sup>

Suite 2.2 – 112 m<sup>2</sup>

Suite Superior – 200 m<sup>2</sup>

Double Rooms (total 62):

8 × Double Room 1 – 51 m<sup>2</sup>

54 × Double Room 2 – 55 m<sup>2</sup>

## POOLS:

1 Indoor pool: 6 m × 12 m

1 Outdoor pool: 10 m × 25 m

Pond: 10 m × 50 m

## PARTNERS FOR LANSERHOF MARBELLA

Single Home – Project developer - [www.singlehome.es/](http://www.singlehome.es/)

San Jose – General contractor / construction company - [www.constructorasanjose.com](http://www.constructorasanjose.com)

Torras y Sierra – Architects - [www.torrasysierra.com/](http://www.torrasysierra.com/)

Ángel Verdú – Interior architect - [www.angelverdu.com/](http://www.angelverdu.com/)

Christoph Ingenhoven Architects – Consulting architect - [www.christophingenhovenarchitects.com/](http://www.christophingenhovenarchitects.com/)

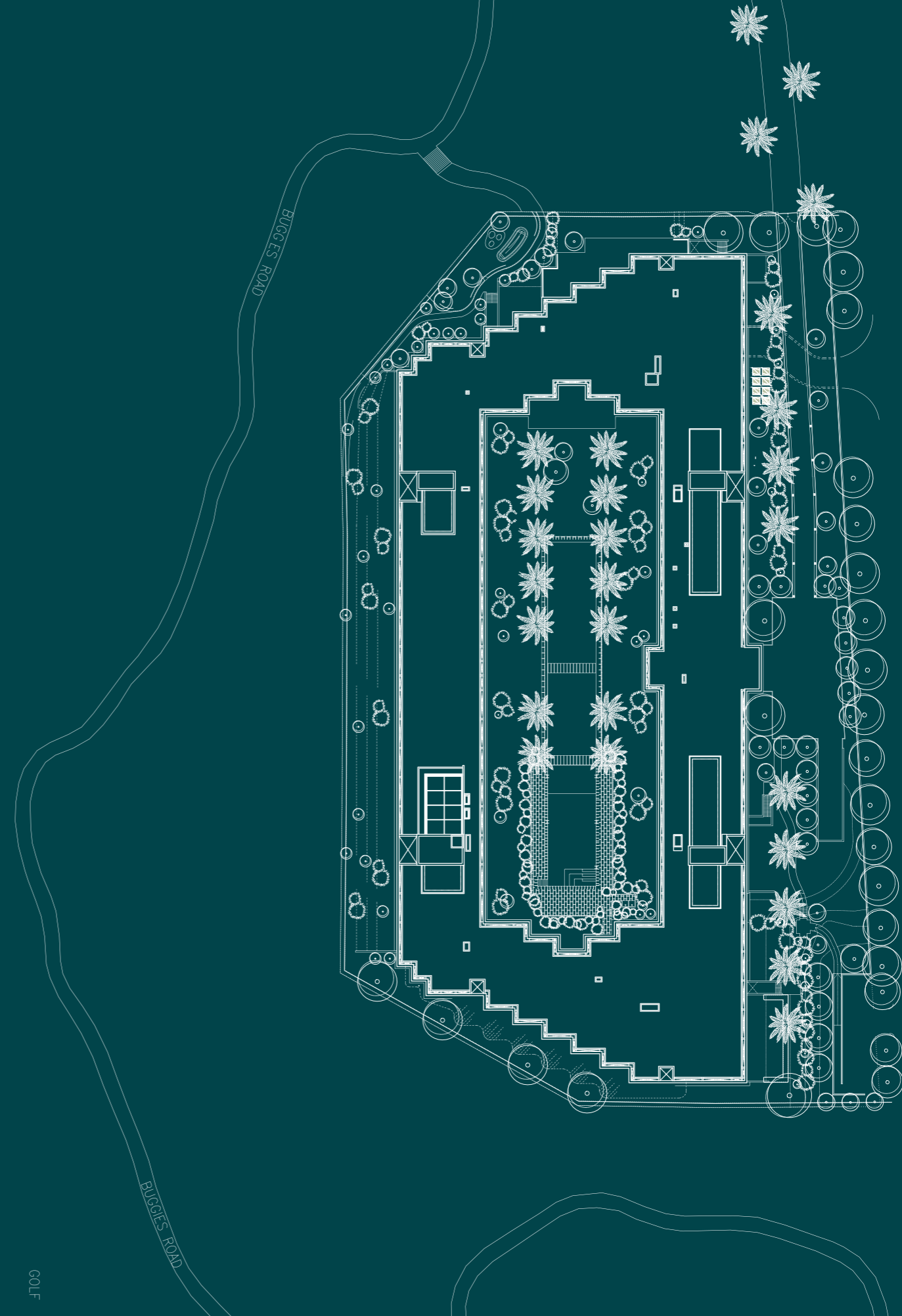

## INTERIOR DESIGN

The interiors are shaped by calm, earthy tones that reflect the surrounding landscape of Casares. Natural materials, warm sandstone hues and sun-washed surfaces create a sense of grounded serenity. Architectural screens and vertical wooden lattices introduce rhythm and texture, echoing the Moorish craft traditions of Andalusia without imitation or ornament. The influence of the Alhambra is subtle rather than thematic—light filtered through structured elements, soft shadow patterns, and an emphasis on quiet geometry.

The rooms are composed to feel restorative. Pale woods, sand-coloured textiles and finely woven fabrics create a gentle tonal gradient from floor to wall. Furniture pieces are rounded and tactile, designed to encourage relaxation rather than visual stimulation. Large windows frame the landscape, allowing daylight to become a central material in the space.

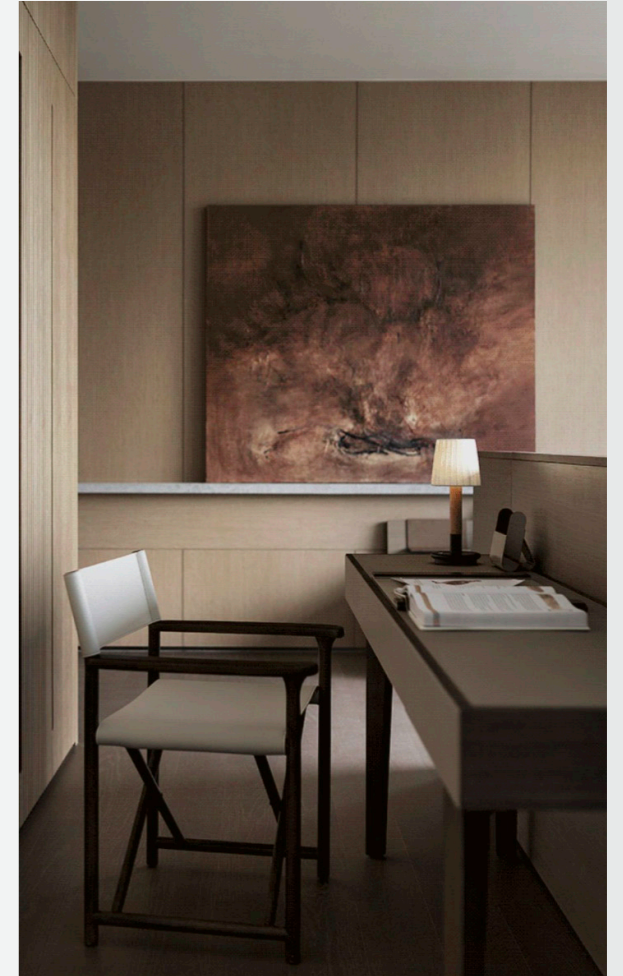

Ángel Verdú – Interior architect - [www.angelverdu.com](http://www.angelverdu.com)

*Images are illustrative examples and may differ from the final execution. They are provided for marketing purposes only.*

# THE PATH TO COMPLETION



The development of Lanserhof Marbella is guided by a precise construction schedule, ensuring that every stage is completed to the highest standards. From the groundbreaking to the grand opening, each milestone marks steady progress towards welcoming our first resort in southern Europe in early 2027.

Visit our website and stay up-to-date with the newest developments on the project.

<https://lanserhof.com/en/lanserhof-marbella/>

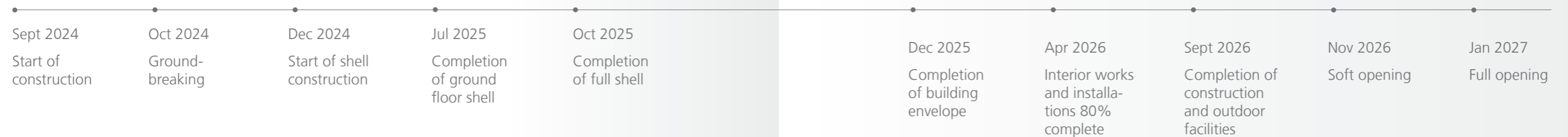

# THE LANSERHOF RESORTS

## LANSERHOF LANS

Lanserhof Lans is located on the sunny Lanser Plateau, nestled at the edge of the forest amidst the stunning Tyrolean mountains. With panoramic views of the Nordkette and the surrounding southern peaks, it offers a space to restore energy, strengthen body and mind, and achieve lasting balance. The resort's architecture combines flowing forms, light-filled spaces, and harmonious colours, creating an atmosphere of calm and well-being.

Since January 2017, Lanserhof Lans has been shining in a new light: south of the main building, which houses 51 rooms and suites, a modern oval annex adds 16 additional rooms and suites, some with private green rooftop terraces. Spacious balconies and the newly redesigned restaurant offer breathtaking views of the Tyrolean landscape and invite guests to relax and unwind.

Additional highlights include a bathing house with a modern sauna area, a heated indoor and outdoor seawater pool, a medical cryotherapy chamber reaching temperatures as low as minus 110 degrees, and expanded medical facilities. The continuous modernization of the hotel area focuses on sensitive integration with the surrounding Alpine scenery.

The medical portfolio at Lanserhof Lans includes therapeutic blood purification, particularly effective for chronic conditions and holistic regeneration. It is complemented by personalized programmes focused on women's health and integrative therapies that combine energy-based and consciousness-enhancing methods with scientifically grounded medicine – always with the goal of creating a sustainable balance between physical vitality and inner harmony.





## THE LANSERHOF RESORTS

### LANSERHOF TEGERNSEE

Nestled in the foothills of the Bavarian Alps, with breathtaking views over the Tegernsee valley, Lanserhof Tegernsee is a sanctuary for recharging energy, promoting sustainable relaxation, and reconnecting with yourself. Spread across more than 21.000 m<sup>2</sup>, the health resort provides a sanctuary for rest, renewal, and holistic well-being.

The architecture and surroundings play a central role in Lanserhof's health experience. Minimalist and timeless design allows guests to focus on the essentials – themselves. The main building is inspired by monastery architecture and features a green inner courtyard, an oasis of calm and tranquillity. The 70 rooms and suites, each with a private balcony or terrace overlooking the Alpine landscape, are elegantly designed and bathed in natural light, offering a private retreat with a sense of well-being and home.

In this inspiring setting, Lanserhof's doctors and therapists devote time to each guest's individual needs, helping them regain lasting strength and vitality. A highlight of the resort is the holistically designed Brain Health Center, dedicated to neurodegenerative diseases and combining preventative and therapeutic approaches. The comprehensive medical portfolio also includes therapeutic blood purification, particularly effective for chronic conditions and overall regeneration, as well as exclusive aesthetic programmes that harmonise outer beauty and inner balance.

Renowned as Europe's most award-winning medical and wellness resort, Lanserhof Tegernsee combines architectural elegance, privacy, and complete peace with cutting-edge holistic medicine.

# THE LANSEHOF RESORTS

## LANSEHOF SYLT

Located on the unique island of Sylt – directly by the sea, surrounded by rolling dunes, and nestled in the middle of List – Lanserhof Sylt is a truly magical place where personal health takes center stage. Perched on one of the island's highest elevations, it offers breathtaking panoramic views of the Wadden Sea, the Lister harbor, and the adjacent protected landscapes. Here, the exceptional North Sea climate, unspoiled nature, and vast landscapes form a perfect harmony with the renowned LANSEHOF CONCEPT, creating ideal conditions for sustainable regeneration and the revitalisation of body, mind, and soul.

The architecture of Lanserhof Sylt is thoughtfully integrated into the dune landscape, emphasizing the connection to nature and supporting holistic recovery. Natural, hand-selected materials, harmonious and understated interiors, elegant forms, subtle colours, and generous spaces with constant views of the sea and dunes all contribute to a profound sense of calm. A highlight of the resort is the freestanding, circular staircase spanning five floors and forming the atrium at the heart of the building. This striking architectural feature leads from the underground car park to the top floor, connecting the resort's 20.000 m<sup>2</sup> of floor space, which includes 55 rooms, treatment areas, and a medical centre covering 5.000 m<sup>2</sup>.

As Lanserhof's first seaside resort, it provides the perfect environment for guests focusing on cardiological rehabilitation, as well as the treatment of respiratory and dermatological conditions. Sylt's restorative climate and exceptionally pure air naturally support recovery and overall well-being. The medical offering is complemented by specialised post-cancer programmes and holistic concepts designed to nurture mental health – from building stress resilience to promoting restorative sleep.

At Lanserhof Sylt, guests experience privacy, generosity, and a sense of deceleration that allows full focus on the body's needs. The health-promoting architecture, combined with a reduced, timeless design that mirrors the surrounding nature, creates space to breathe, relax, and gather new energy. The flowing, edge-free architecture in harmony with Sylt's enduring landscapes enables the body to activate its self-healing powers in a new and sustainable way. Here, the wilderness of the rough seaside, the idyllic mudflats, and the serene heathlands become the measure of all things – guiding each guest toward holistic regeneration, balance, and lasting well-being.



# HOW TO FIND US

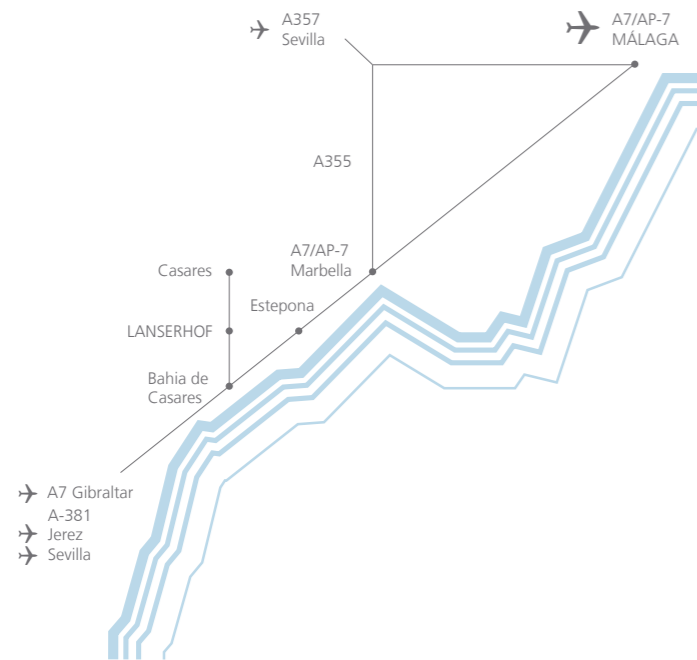

Lanserhof Marbella  
Carretera Casares, km2  
29690 Casares, Málaga  
Spain

## OUR OTHER LOCATIONS

Lanserhof Sylt  
Am Lanserhof 1–8, 25992 List on Sylt  
Germany  
T +49 4651 995957-0  
info.sylt@lanserhof.com

Lanserhof Lans  
Kochholzweg 153, 6072 Lans  
Austria  
T +43 512 38666-0, F +43 512 378282  
info.lans@lanserhof.com

Lanserhof Tegernsee  
Gut Steinberg 1–4, 83666 Marienstein/Waakirchen  
Deutschland  
T +49 8022 1880-0, F +49 8022 1880-499  
info.tegernsee@lanserhof.com

Legal notice

Responsible for content:  
Dr Christian Harisch (CEO),  
Christian Siegling (COO)

Design  
Lanserhof

Editing  
Lanserhof

Photography and visualisations  
Berga González, Alexander Haiden,  
André Josselin, Maximilian König,  
Ángel Verdú, Adrián Zapatera Rollán

**LAN  
SER  
HOF**

[www.lanserhof.com](http://www.lanserhof.com)